

ConcreteMaster™ (BLD3050)

Non-Invasive Concrete Moisture Meter

The ConcreteMaster is a non-invasive, rapid test moisture meter for concrete and gypsum materials meeting ASTM F2659 guidance.

Features

- Measures up to ¾" (19 mm) below the surface
- Adjustable auto off
- Audible tone
- Hold feature
- Backlit LCD display
- Color arc LED display
- User field calibration
- Over the air software upgrade
- Multilingual UI
- Bluetooth data reporting with Protimeter Connect

Applications

- Flooring Installation
- Building restoration
- Concrete and gypsum moisture measurement

Benefits

- Non-destructive quick screening of concrete and gypsum moisture content
- Not adversely affected by surface moisture such as condensation
- Dual display LCD and LED for easy reading
- Color changing LEDs to show moisture condition: green (dry), yellow (at risk), and red (wet)



Bluetooth Enabled

ConcreteMaster™ Specifications

Dimensions (h x w x d)

7.1 in (18 cm) x 2.5 in (6.5 cm) x 2.2 in (5.5 cm)

Display 1

Digital LCD

Display 2

Multi-color LED arc:

- Green (dry)
- Yellow (at risk)
- Red (wet)

Measurement Range

Scale

	Range
Concrete Percent Moisture Content	0 – 7%
Carbine Method Concrete	0 – 4.3%
Gypsum Reference	0 – 12
Reference	0 - 99

Depth of Moisture

Up to 3/4 in (19 mm)

Case

Pouch with belt loop

Power

3V (2 x AA) 2700mAh

Gross Weight

240 gm

Warranty

2 years on mechanical or manufacturing defects. Does not include wearing part or accessories. Extendable warranty with equipment registration.

Part Number

BLD3050

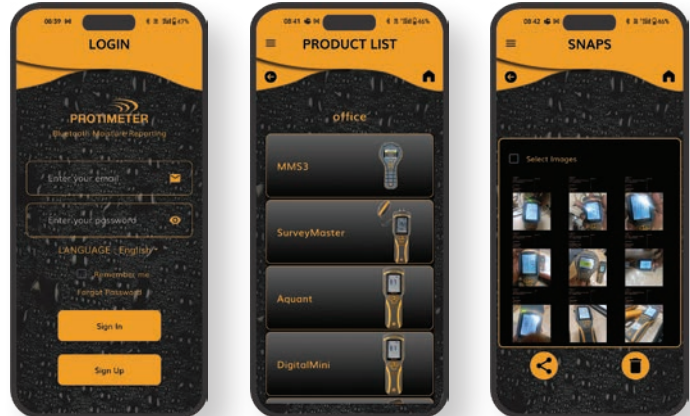

Protimeter devices with Bluetooth are able to use the free Protimeter Connect App. The app allows users to record measurement readings and photos.

Amphenol Sensors

www.protimeter.com

www.amphenol-sensors.com

© 2025 Amphenol Corporation. All Rights Reserved. Specifications are subject to change without notice. Other company names and product names used in this document are the registered trademarks or trademarks of their respective owners.

AS-920-817A - 01/2025